

OUTLINE DIMENSION

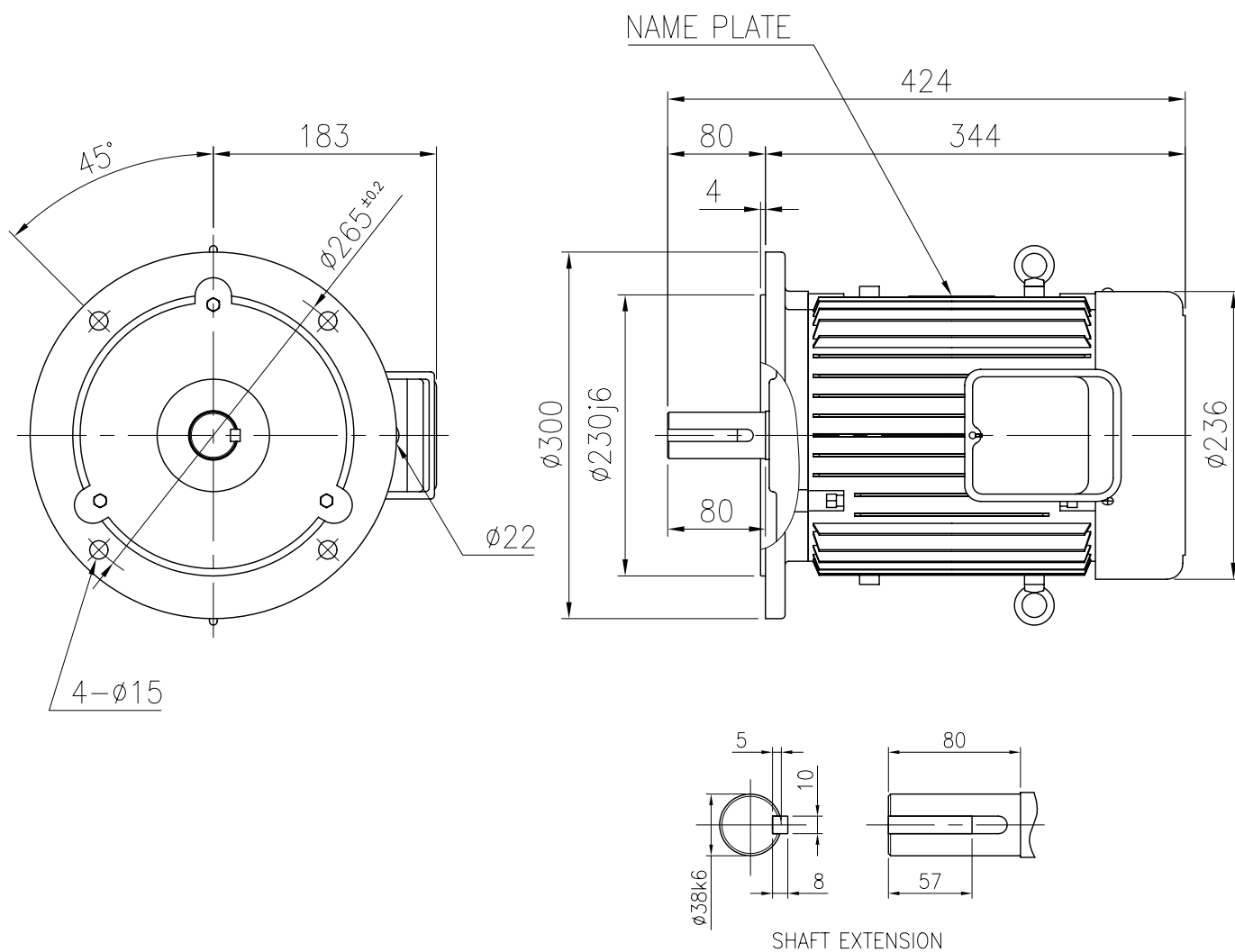

<NOTE>

1. TYPE : TEFC(Totally Enclosed Fan Cooled)
FOOTLESS MOUNTED TYPE
2. THE TOLERANCE FOR THE KEY DIMENSIONS
IS IN ACCORDANCE WITH KS B 1311-84
3. THE TERMINAL BOX MAY BE ROTATED
STEPS OF 90°

4. ALUMINUM DIE CASTING FRAME AND
CAST IRON END BRACKETS.
-
5. STAINLESS STEEL NAME PLATE
-
6. STEEL FAN COVER AND TERMINAL BOX.

FRAME NO.	OUTPUT (kW)				INS. CLASS	PRO-TEC-TION	RA-TING	BEARING NO.						APPROX. WEIGHT (Kg)		
								2 P		4 P		6P / 8P				
	2P	4P	6P	8P				DRIVE	OPP.D.	DRIVE	OPP.D.	DRIVE	OPP.D.	2P	4P	6P/8P
FF265	7.5	—	—	—	F	IP44	CONT.	6208ZZ	6305ZZ	—	—	—	—	50	—	—

UNIT	mm	SCALE	$\frac{N}{S}$	PROJECT'N	3rd Angle	TITLE	OUTLINE
DESIGNED		CHECKED		APPROVED			
2006.09.20 H. G. HAN		2006.09.20 H. J. KIM		2006.09.20 H. T. KIM		SUBJECT	FF265, V1
Otis Elevator Korea						DWG. NO.	DW-KMB-10HK3F